

ARCORA® INTERNATIONAL

OPERATION MANUAL



Dear customers

You probably want to get to know your new Hoover as quickly as possible and be able to operate it safely. Please read these instructions for use before you start using the appliance.

To avoid accidents and damage, start with the chapter >>Safety instructions<< and be sure to observe the instructions listed here.

Content

Description of the vacuum cleaner	Section	1
Operating elements	Section	2
Handling	Section	3
Safety instructions	Section	4

Section 1

Description of the vacuum cleaner

The M5PLUS vacuum cleaner can be used as a dry vacuum cleaner for cleaning large areas in offices, hotels, restaurants, doctors' practices, shops. The vacuum cleaner can be used to clean hard floors (stone, parquet, plastic) as well as soft floors (carpets, upholstered furniture, curtains). The robust and modern construction guarantees a long service life and convenient operation with low usage costs.

Technical Details

Power supply: 230V, 50 Hz

Power cable: ca. 15 m

Max. capacity: 900 W

Vacuum: 2700 mm H₂O

Features: Protective insulated (class II),
interference-suppressed, CE-sign



Section 2

Operating elements

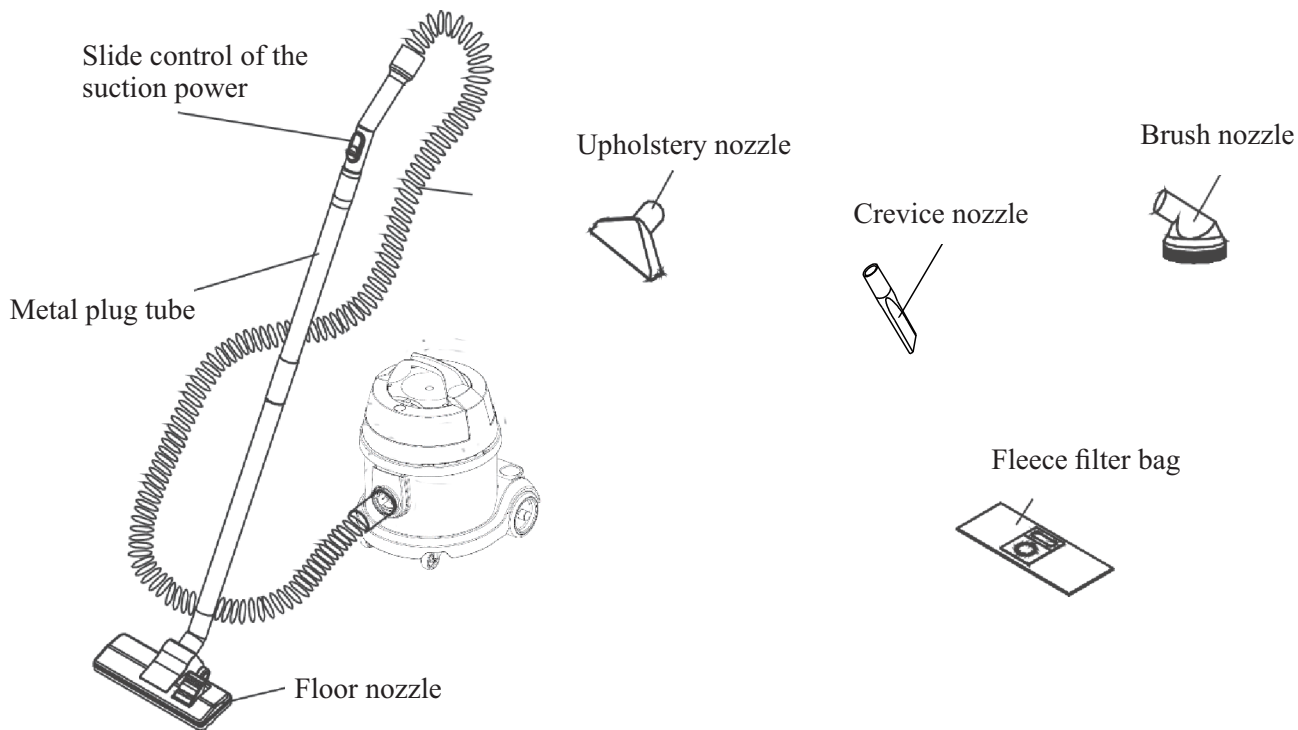

Section 2

Operating elements

The flexible suction hose with rotating end pieces facilitates the operation of the accessories. The bleed valve is on the handle of the suction hose.

With the slider of the valve you can adjust the suction power, especially recommended for curtain cleaning.

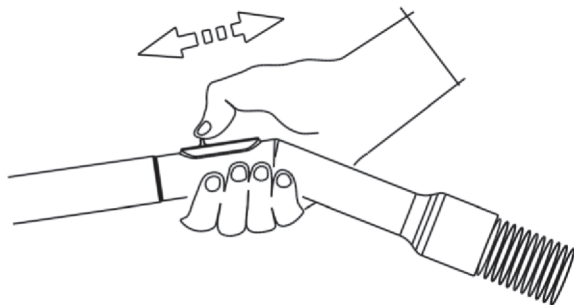

Connect the metal tube with the handle of the suction hose and the accessory to the pipe.

Upholstery nozzle

With the upholstery nozzle you can dust off upholstered furniture, mattresses, pillows, curtains, etc.

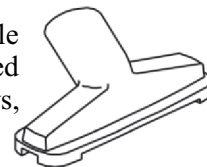

Brush nozzle

The brush nozzle is suitable for extracting uneven surfaces, such as profile strips.



Crevice nozzle

The crevice nozzle is suitable for the suction of wrinkles, joints and corners or niches that you can't reach with the floor nozzle.



Section 2

Operating elements

Floor nozzle

The floor nozzle is the most commonly used element of the accessory. It is suitable for large flat surfaces such as carpets or floors. For vacuuming smooth floors such as PVC, parquet or stone, the floor nozzle is additionally equipped with a brush. If necessary, press your foot on the rocker arm to extend or lower the brush. Carpets and carpets should be vacuumed without a brush. To do this, push the toggle switch forwards.

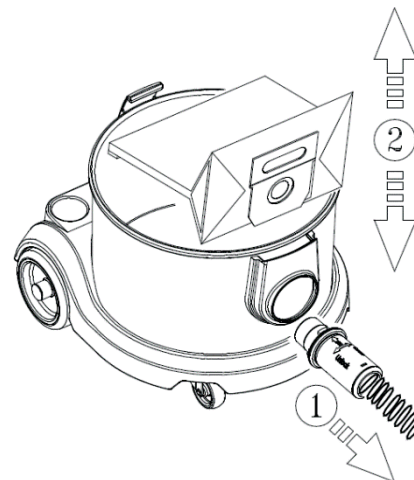
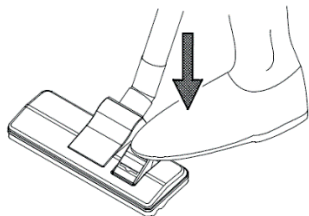

Fleece filter bag

The extremely tear-resistant fleece filter bags offer a high degree of dust retention and, compared to paper filter bags, allow significantly longer vacuuming cycles.

Attention: To insert or replace the bag you must first pull out the suction hose.

Section 3

Handling

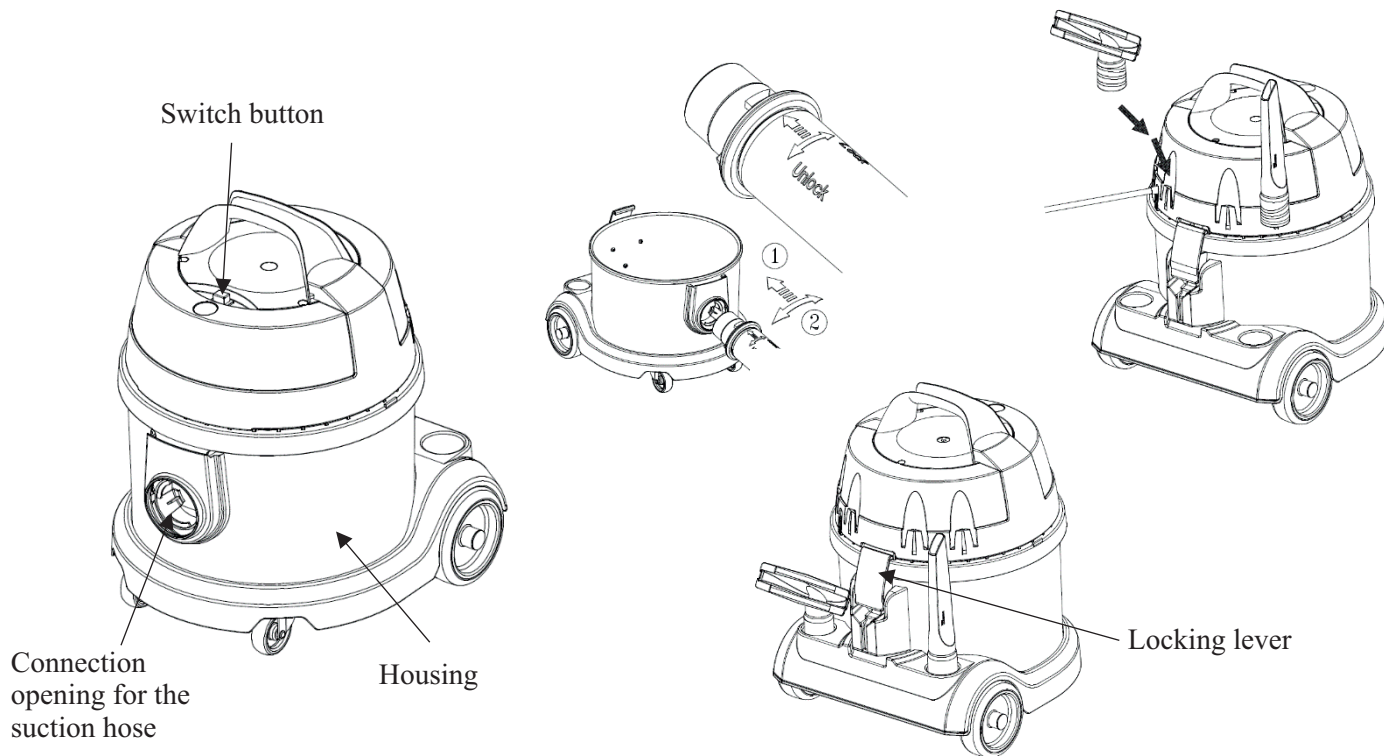

Before switch on the vacuum cleaner:

- ◆ Please make sure that the fleece filter bag is correctly inserted in the housing inlet. Do not use the vacuum cleaner if no dust bag is inserted.
- ◆ Insert the suction hose into the connection opening and turn it slightly to the right or to the left to lock.
- ◆ Insert metal pipes into each other and put them together with the handle of the hose. Place the necessary nozzle on the lower end of the suction pipe.
- ◆ Plug the power plug into the socket.
- ◆ Press the switch button to switch on the device.

After vacuum

Once cleaning is complete, turn off the power.

To switch off, tap on switch button.

Disconnect the power plug from the socket.

Replacing the dust bag

- ◆ Turn off the vacuum cleaner and pull out the plug.
- ◆ **Remove the suction hose from the device.**
- ◆ Unlock the dust bag chamber with the cover lever, remove the cover.
- ◆ Grasp the dust bag and pull it out.
- ◆ Insert a new dust bag into the dust bag chamber.
- ◆ Close the lid again, check before commissioning whether all components are properly installed.

Section 3

Handling

Replacing the foam and motor protection filter .

From time to time, the foam and motor protection filters must be changed. In the event of visible contamination, you can clean them by rinsing in lukewarm water with a little detergent and after complete drying, replace the cover.

HEPA-Filter

- ◆ Remove three screws in the lid, take off the lid and remove the foam filter.
- ◆ Insert a new or cleaned filter.
- ◆ Put the lid on and tighten the screws.

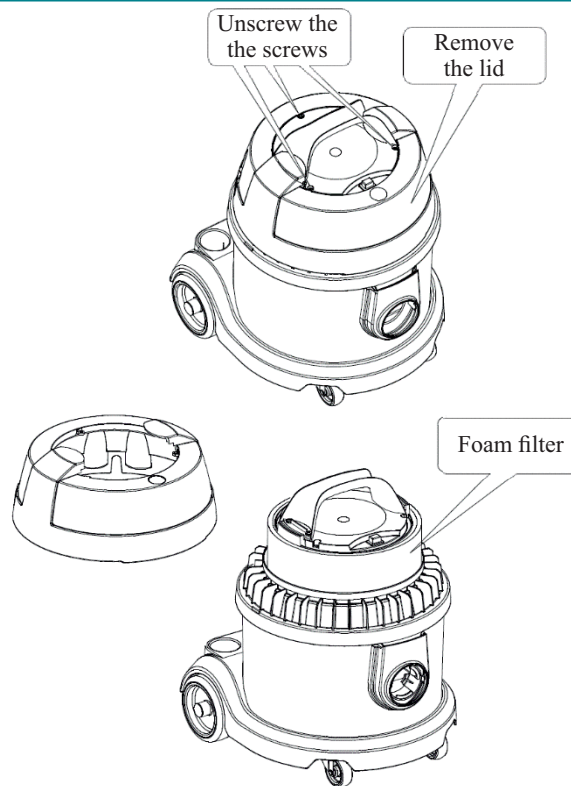

Section 3

Handling

Motor protection filter

- ◆ Turn off the vacuum cleaner.
- ◆ Remove the lid.
- ◆ Remove the motor protection filter from the motor cover.
- ◆ Insert a new or cleaned motor protection filter.

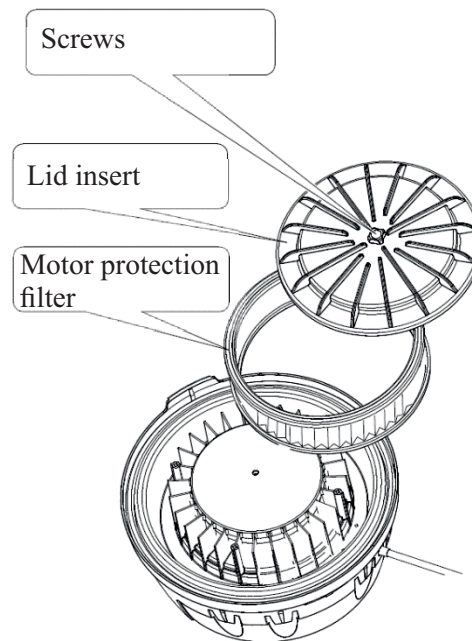
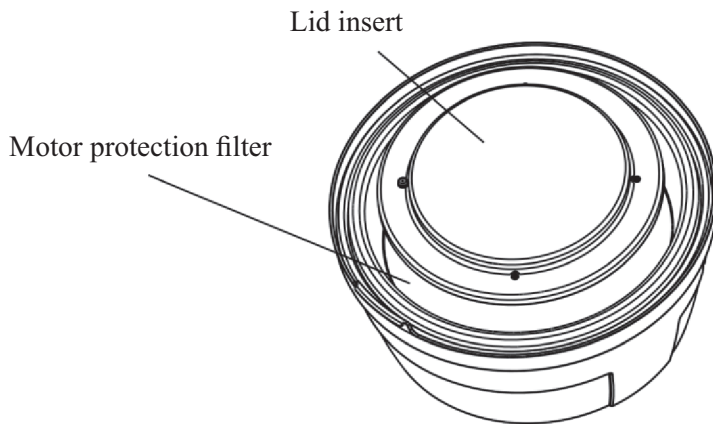

Safety instructions

- ◆ Please note that improper handling of electrical appliances may present hazards that may not be detected by children. Have children work with the device only under the supervision of an adult.
 - ◆ Repairs to electrical appliances may only be carried out by authorized specialists. If the power cord of this equipment is damaged, it must be replaced by the manufacturer or service center or a similarly qualified person to avoid hazards. Improper repairs can result in serious danger to the user. In case of self-made repairs, improper connection or incorrect operation liability and warranty claims are excluded.
 - ◆ The vacuum cleaner may only be used with the fleece filter bags and filters approved for this machine. Only then is the perfect suction guaranteed. Used or damaged dust bags must not be reused.
 - ◆ Never leave the appliance in damp rooms after use. Never vacuum up water or other liquids or wet dirt.
 - ◆ Do not vacuum glowing ashes, burning cigarettes or sharp objects, glass splinters, plaster, cement or stone dust with the vacuum cleaner.
 - ◆ Disconnect the device from the power supply when cleaning it, change the dust bag or filter or leave it unattended.
-

